

Smartfix®

Over 50% less handling

1 Cut panel to size

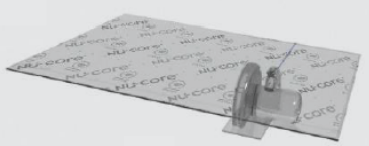

2 Edge route full perimeter of panel

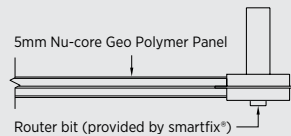

3

Panel ready for installation

Conventional Cassette Fix - Leading Brand

1

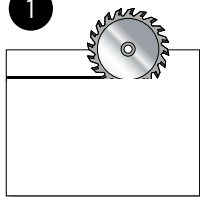

2

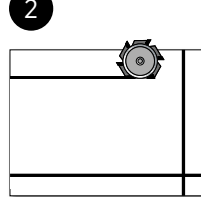

3

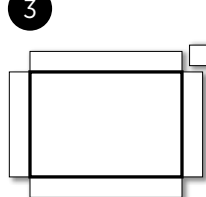

4

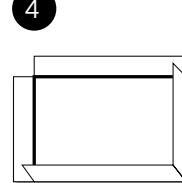

5

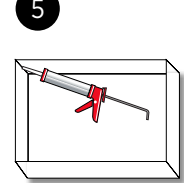

6

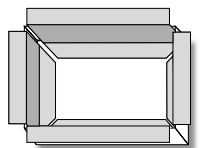

7

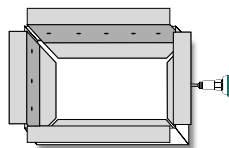

8

Panel ready for installation

1. Cut panel to size
2. V groove full perimeter of panel to allow for cassette fold
3. Punch out corners and sides of panel to allow for hanging panel (if not using angle fixing)
4. Fold all four sides of panel (material wastage)
5. Caulk inside fold full perimeter
6. Measure and cut supporting angle (for inside of cassette panel for support)
7. Screw support angle to inside of cassette panel
8. Panel ready for installation

Smartfix® Mechanical System

2m² visible cover = 2000mm x 1000mm (no folds)

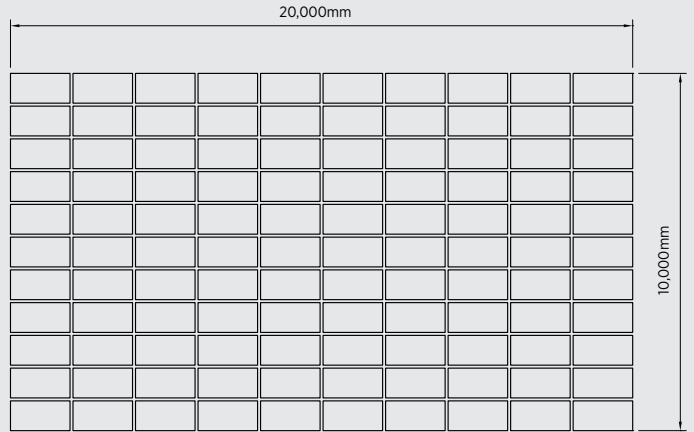
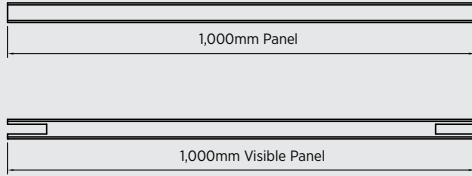

200m² visible area
 200m² of panels used
0% additional material

Conventional Cassette (tray) system

2m² visible cover = 2100mm x 1100mm (50mm folds)

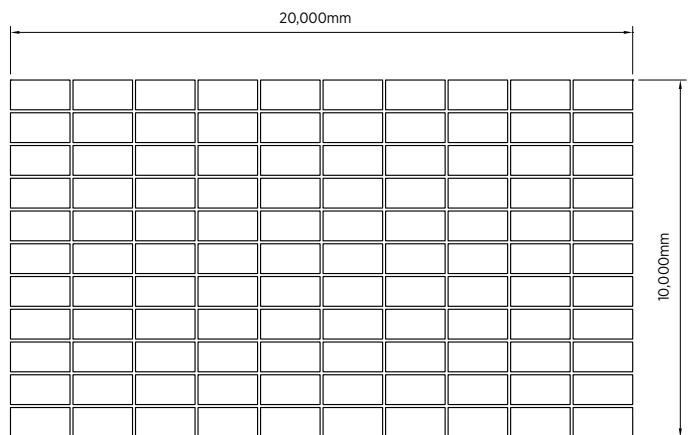
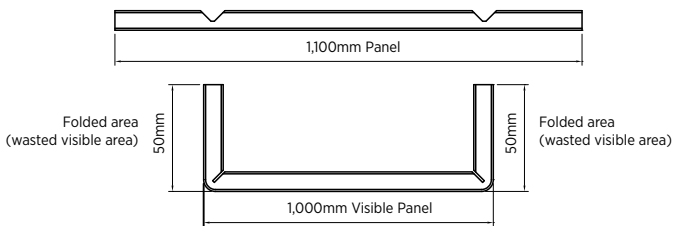

200m² visible area
 234m² of panels used
17% additional material